

**round duct grille
KG-RR**



Ferdinand Schad KG
Steigstraße 25 - 27
78600 Kolbingen
Telefon (07463) 980 - 0
Telefax (07463) 980 - 200
info@schako.de

KG-RR

round duct grille

contents

Description	3
Construction	3
Model	4
Fixing	4
features	4
Models and dimensions	5
Dimensions	5
Technical data	7
Legend	7
Order details	8
Specification texts	9

KG-RR

round duct grille

Description

In modern architecture, round sheet metal ducts and foldet spiral seam ducts of air conditioning systems are often incorporated into the design of the room. Section of the system are intentionally left on display. The visible installation of the ventilation ducts allows air diffusers to be integrated into the pipes.

The round duct compact grille type KG-RR can be used for both supply and extract air systems. The air volumes can be regulated by using the integrated hit and miss damper. The hit and miss damper ensures an equal distribution of supply air along the whole length of the grille. The round duct grille can be installed at any point of the duct system. The frontside horizontal and vertical blades can be adjusted. Diverse air jet paths can be chosen and set. As a result, the air jet disperses so that the fresh air is distributed across a larger area of the occupied zone.

The high expenditure to adjust this duct system can be considerably reduced by installing the additional volume control adjustment system type MES.

Accessories such as dummy pipes, end section covers and connecting sleeves complete our range of duct diffusers. (See documents: Accessories for round duct systems).

Selection

The round duct grille KG-RR is selected according the diagrams of the grille type KG.

Blade settings

KG-RR-H 8

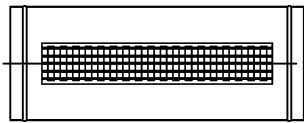

either left or right throw possible

symbol



slanted upwards



slanted downwards

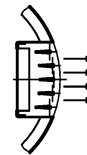

horizontal

KG-RR-V 8

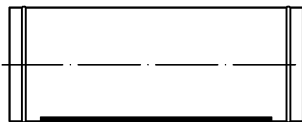

symbol

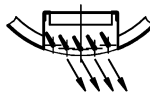

right

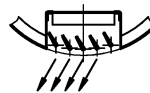

left

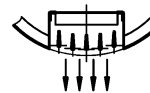

vertical

KG-RR-H/-V 15

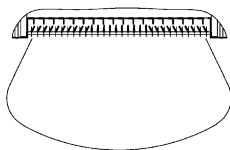

divergent air pattern possible

Construction

round duct grille

- painted sheet steel RAL 9010 (white)
- raw aluminium
- Stainless steel 1.4301 (V2A) coloured in sand silver

Model

- KG-RR-V - vertical throw
- KG-RR-H - horizontal throw, both left and right hand air flow possible
- KG-RR-...-8 - horizontal air deflection blades

KG-RR

round duct grille

Fixing

Mounting

- ready to be mounted using a M8 adjustment rod provided by the customer

features

Attention!

We would like to draw your attention to the fact that the stainless models are exclusively to be cleaned by using a special cleanser.

KG-RR round duct grille

Models and dimensions

Dimensions

KG-RR-V 8

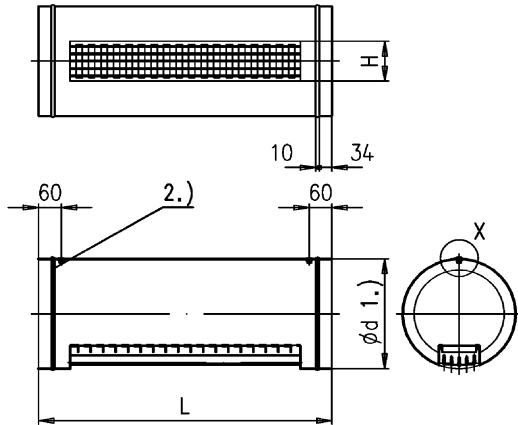

KG-RR-V 15

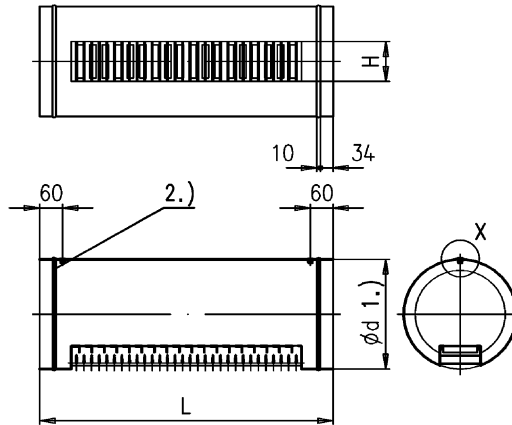

detail X

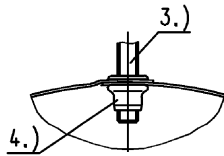

- 1.) external
- 2.) reinforcement from size 500
- 3.) on site
- 4.) M8 screw

available sizes

NW	ød	H				L	NW	ød	H				L	
		65	115	215	315				65	115	215	315		
200	198	x	x	-	-	I	500	450	348	x	x	x	x	1500
224	222	x	x	-	-		500	500	498	x	x	x	x	
250	248	x	x	x	-	I	750	560	558	x	x	x	x	1750
280	278	x	x	x	-		750	630	628	x	x	x	x	
315	313	x	x	x	-	I	1000	710	708	x	x	x	x	2000
355	343	x	x	x	x		1000	800	798	x	x	x	x	
400	398	x	x	x	x		900	898	x	x	x	x		

All combined lengths and height available.

- x = available
- = not available

- I = 1 section
- II = 2 sections

KG-RR

round duct grille

models

KG-RR-H 8

KG-RR-H 15

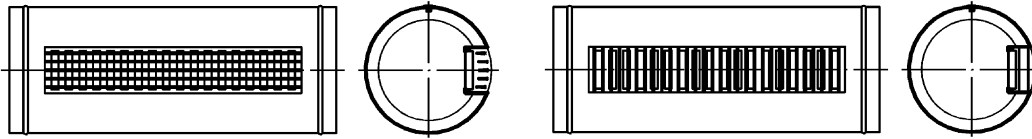

both left and right hand air throw possible. The duct has to be installed accordingly.

division in length

1-part

Length 500

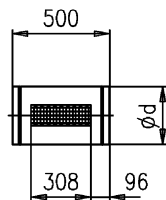

2-part

Length 1500

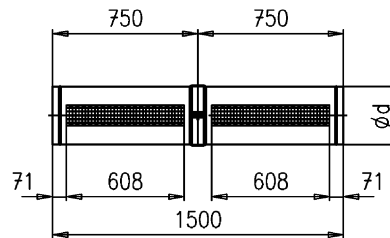

Length 750

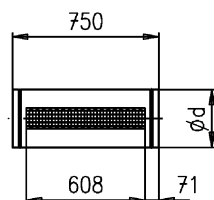

Length 1750

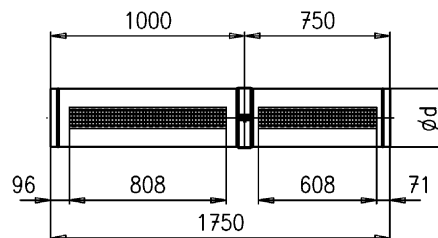

Length 1000

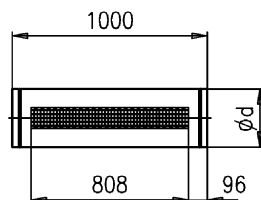

Length 2000

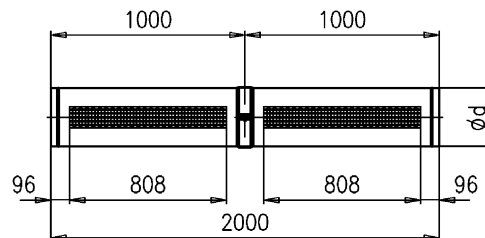

The nozzle diffuser with integrated ducts with a length of >1000 are delivered in two sections and are connected with a sleeve in factory. There are no rivetted nuts on this side. The dimensions of the dummy pipe and the nozzle with integrated duct type KG-RR are compatible. Other lengths are possible on request. Max. length of a middle or end piece is 1000 mm.

KG-RR

round duct grille

Technical data

Legend

H = height
L = length
NW = nominal diameter

KG-RR round duct grille

Order details

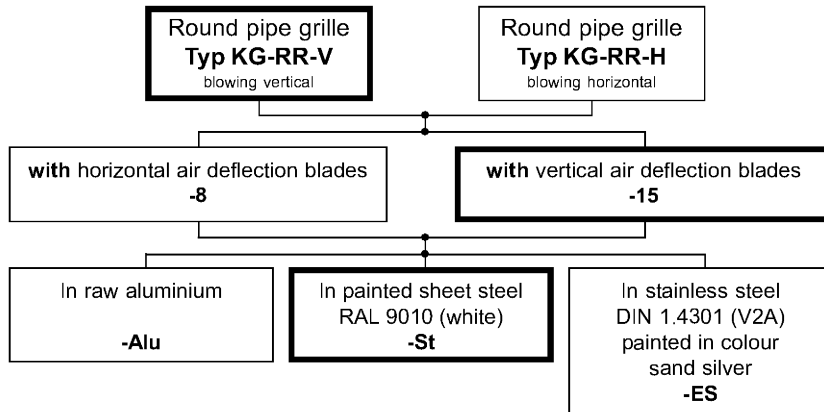

Order example:
KG-RR-V-8-St

At non-specified order the thick framed design will be delivered!

KG-RR

round duct grille

Specification texts

Round duct compact grille type **KG-RR 8** for supply and extract air for connection in round DIN ducts, with integrated manual adjustable hit and miss damper for commissioning. With frontside horizontal adjustable air deflection blades.

- Vertical jet path
Manufacturer: SCHAKO **type KG-RR-V 8**
- Horizontal jet path
Manufacturer; SCHAKO **type KG-RR-H 8**
- Round duct compact grille (round duct with blades and hit and miss damper) consisting of:
 - painted sheet steel RAL 9010 (white)
 - untreated aluminium
 - stainless steel 1.4301 (V2A) painted in 'sand silver'

Round duct compact grille **type KG-RR 15** for supply and extract air for connection in round DIN ducts, with integrated manual adjustable hit and miss damper for commissioning. With frontside vertical adjustable air deflection blades.

- Vertical jet path
Manufacturer: SCHAKO **type KG-RR-V 15**
- Horizontal jet path
Manufacturer: SCHAKO **type KG-RR-H 15**
- Round duct compact grille (round duct with blades and hit and miss damper) consisting of :
 - painted sheet steel RAL 9010 (white)
 - raw aluminium
 - stainless steel 1.4301 (V2A) painted in sand silver.